



**CARTER**REMY  
ESTATES



14 Hockley Close  
£260,000-£300,000

🛏 2 🍳 1 🚿 2





£260,000-£300,000 Discover the allure of Hockley Close – a must-see residence offering unrivaled convenience with the town center just moments away and effortless access to A127 & A13. Nestled in Basildon's coveted neighborhood, this impeccably presented two-bedroom terraced house caters to the discerning tastes of families and commuters seeking a comfortable and well-connected living space.

Step into the expansive living room, a haven for relaxation and entertainment, bathed in ample natural light. Flowing seamlessly into a dining area and a versatile conservatory, this home transcends boundaries, creating a space adaptable to various activities. Whether a playroom for little ones, a serene reading nook, or an engaging entertainment area, the conservatory effortlessly bridges the indoor and outdoor realms.

Perfectly situated in Basildon, this residence boasts exceptional transport links, making it an ideal haven for commuters. Positioned conveniently near major roadways and public transportation, it provides effortless connectivity to neighboring towns and cities. The proximity to a myriad of amenities, including schools, shops, and recreational facilities, ensures that all the needs of a growing family are met.

Embark on a journey to a home that seamlessly blends comfort, convenience, and versatility. Hockley Close awaits – your ideal haven in Basildon.





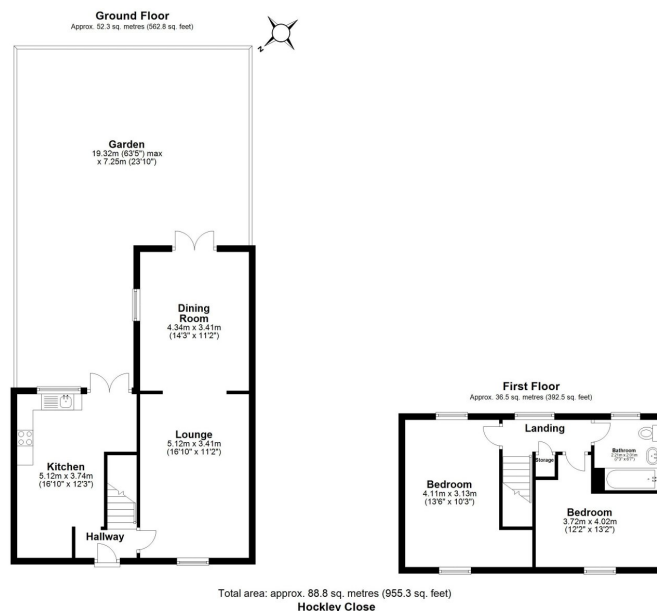

- Two-bed terraced house in a sought-after location of Basildon.
- Dining area and versatile conservatory for various activities
- Ideal for commuters with excellent transport links
- Close to amenities: schools, shops, recreational facilities
- £260,000 to £300,000
- Expansive living room with natural light for relaxation
- Seamless indoor-outdoor connection in the conservatory
- Conveniently located near major roadways and public transport
- Comfort, convenience, and versatility at Hockley Close – your ideal Basildon haven
- Close to town centre

